

FRICITION SLIPPER INSTRUCTIONS

Thank you for choosing this Team Losi slipper. We think you will find this product to be very reliable as well as versatile. The Hydra - Drive portion of the slipper may be added and will attach directly to the slipper assembly.

Assembly

Step 1) Disassemble your transmission and remove your top gear shaft.

Step 2) Insert a 1/16 pin into the hole in the slipper shaft. Attach the internal pinion gear (not supplied) to the slipper shaft by aligning the groove in the gear with the pin and secure the gear with an "E" clip. Attach another E-clip to the groove in the shaft away from the threads. Attach a "C" clip (127) to the groove in the shaft next to the flats. Thread the long 4-40 set screw (128) into the shaft and tighten. A small amount of thread lock should be used.

Step 3) The output hole for the top shaft in the gearbox has been enlarged in later production to accept the slipper backplate. If you are adapting the slipper to a previous version, the hole needs to be enlarged to a 5/16" diameter. Be sure to keep the drill bit centered in the smaller

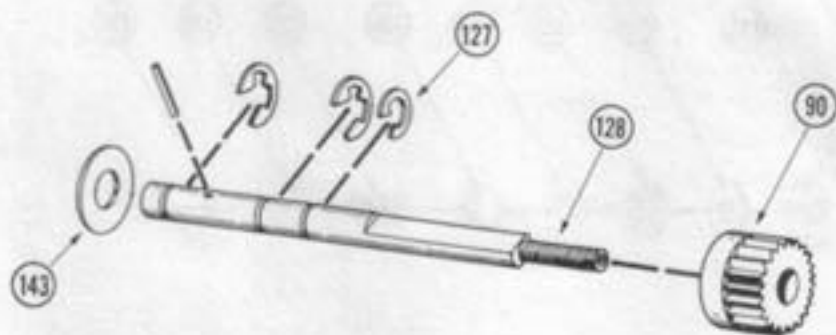

hole. If the larger hole is drilled too far off center, your transmission may not perform properly.

Step 4) Assemble your gearbox with the threaded end of the slipper shaft (128) outside the gearbox and through motor plate. If a shim (143) is required, add to end of shaft as shown in the exploded view.

Step 5) Press a 3/16"x 5/16" bearing (129) into the center of the spur gear (43). The bearing will only press in about half way. **Do not try to force it any further.** Slide the backplate (130) over the gearbox shaft (39), aligning the flat sections of the a gearbox shaft (39) with the flat sections in the backplate (130). Place the slipper pad (131) on the gear plate (132), and align the notches on the gearplate (132) with the notches on the slipper pad (131). Place the slipper pad (131) and gearplate (132) over the slipper shaft (39), pad side first. Try to get this assembly as close to center on the shaft (39) as possible. Carefully install the spur gear * (43) with bearing side out. Lightly rotate the spur gear until the 3 posts line up with the holes in the gearplate (132). Snap into place being very careful to keep the slipper pad (131) aligned. Place the cup (133), open end out, over the shaft. Insert one thrust washer (134) then the thrust bearing (135) followed by the second thrust washer (134). These should all sit into the cup. Place the slipper spacer (136), long side first, onto the shaft. The slipper spacer (136) should line up with the flat spot on the gearbox shaft (39), and sit into the center of the thrust assembly. Place the spring (137) over the gearbox shaft (39) followed by the outer spring spacer (138) and secure with a 4-40 lock nut (139). Tighten the nut until it slightly compresses the spring. While doing so be sure that the slipper pad (131) stays aligned with the gear plate (132).

Step 6) Insert slipper adjustment plug into gear cover and attach gear cover to motor plate.

Adjustment

Before you adjust the slipper you'll want to adjust your diff. First tighten the nut on the slipper so that it will not slip. Next make sure your diff is properly adjusted. Once your diff is properly adjusted, loosen up the slipper adjustment nut once again. Place your car on the track or racing surface and do a "punch off" (full throttle from a stop). The slipper should slip just slightly or for about one foot. Your slipper setting will vary from track to track. For very slippery surfaces you may want to adjust your slipper so that it slips for about 3 feet. On very high bite tracks you may

want to adjust the slipper quite a bit tighter. You can do this by rolling the car backwards and pulling full throttle. The slipper should slip just slightly no matter what the racing surface. You should be absolutely sure that the slipper still slips before the diff. Under no circumstance should the diff be used as a slipper.

* *To further improve the performance of your transmission you may want to try Team Losi's new low friction gear set # A-3024.*

PARTS LIST

38	A-6101	3/16" E-CLIPS
39	A-3120	SLIPPER GEARBOX SHAFT
40	A-3002	MOTOR PLATE
42	A-6401	1/16" X 7/16" SPIROL PIN
43	A-3906	SLIPPER GEAR

90	A-3022	PINION GEAR (SLIPPER SHAFT)
107	A-3004	GEAR COVER (SLIPPER)
127	A-6102	C-CLIPS .1875 (LARGE)
128	A-3120	SLIPPER SHAFT AND HARDWARE
129	A-6905	3/16" X 5/16" BEARING
130	A-3121	BACKING PLATE (SLIPPER)
131	A-3123	FRICTION PAD(SLIPPER)
132	A-3122	GEAR PLATE (SLIPPER)
133	A-3124	SPRINGS, CUP, SPACER & WASHER (SLIPPER)
134	A-3125	9/16" x 1/4" THRUST BEARING ASSY.(SLIPPER)
135	A-3125	9/16" x 1/4" THRUST BEARING ASSY.(SLIPPER)
136	A-3124	SPRINGS, CUP, SPACER & WASHER (SLIPPER)
137	A-3124	SPRINGS, CUP, SPACER & WASHER (SLIPPER)
139	A-6305	4-40 LOCKNUT (SLIPPER)
144	A-3004	GEAR COVER (SLIPPER)

P/N 800-0036

